

# How to Show All Menu Option of the Eclipse II TomTom

When the TomTom is set to show all menu options, there will be 3 Main Menu screens and 8 Preferences screens. When the TomTom is set to show fewer menu options, there are only 2 Main Menu screens and only 3 Preference screens. This selection is important if you want to see all the features the TomTom has to offer.

## Step 1

Touch the center of the map screen

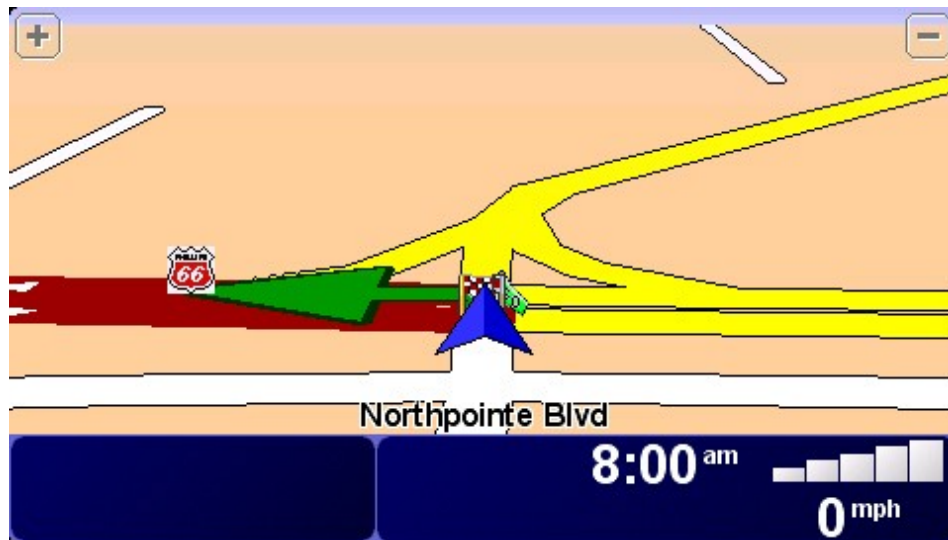

## Step 2

Touch the **Change Preferences** button

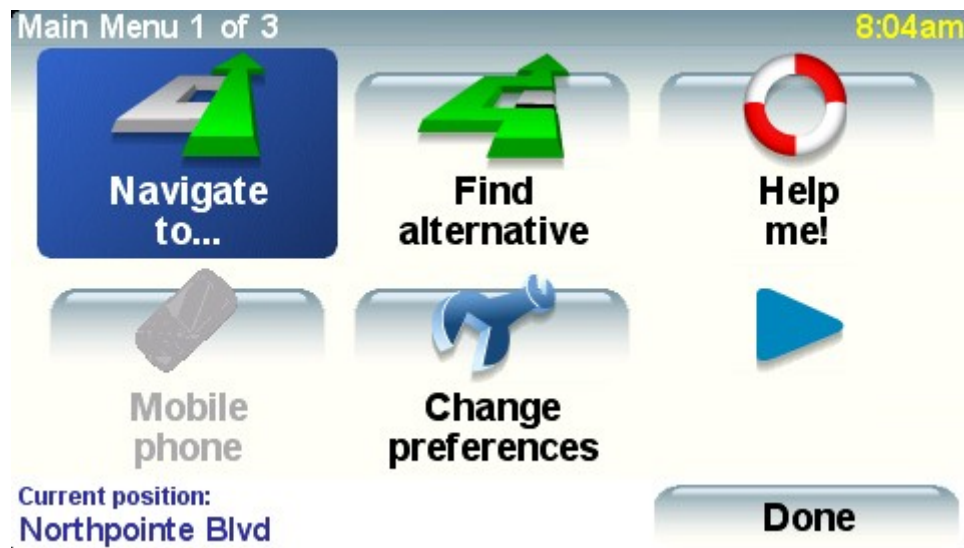

# How to Show All Menu Option of the Eclipse II TomTom

## Step 3

Touch the **blue arrow button** to display Preferences 3 of 3 screen

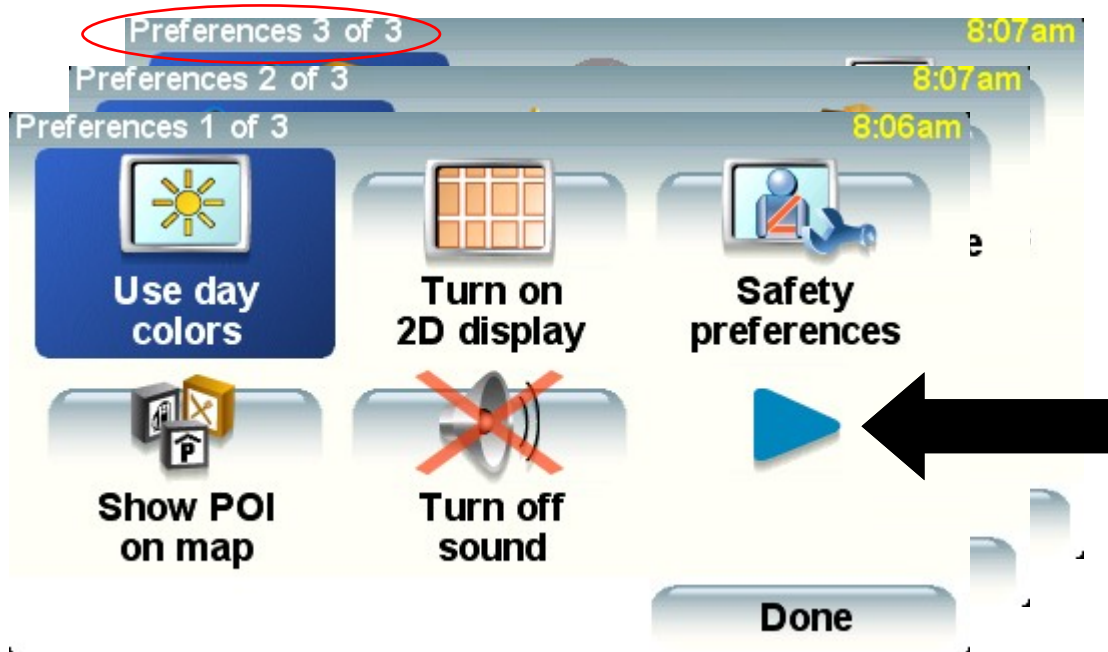

## Step 4

Touch **Show All Menu Options** buttons

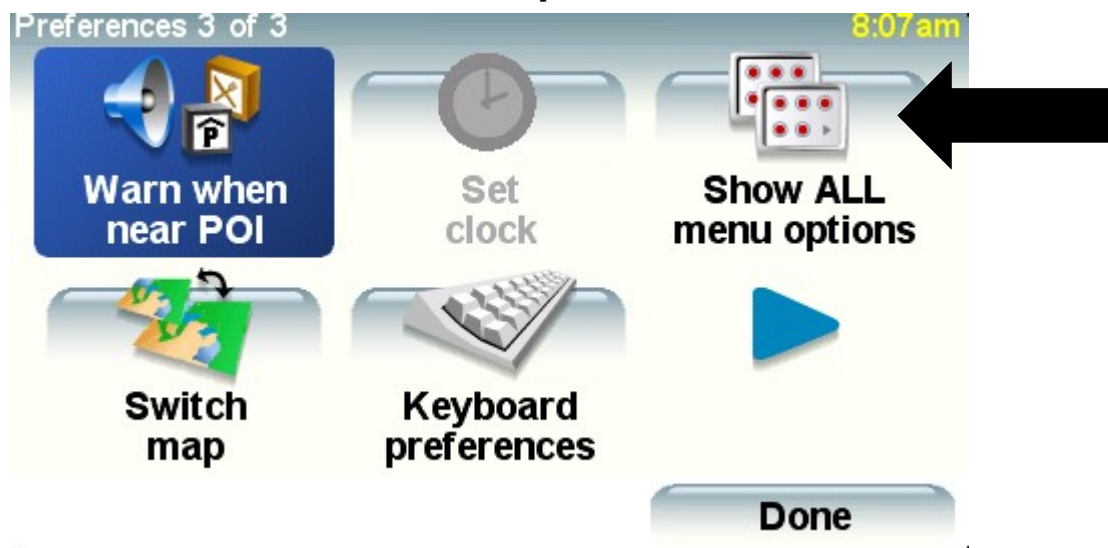

# How to Show All Menu Option of the Eclipse II TomTom

## Step 5

Touch **Continue**

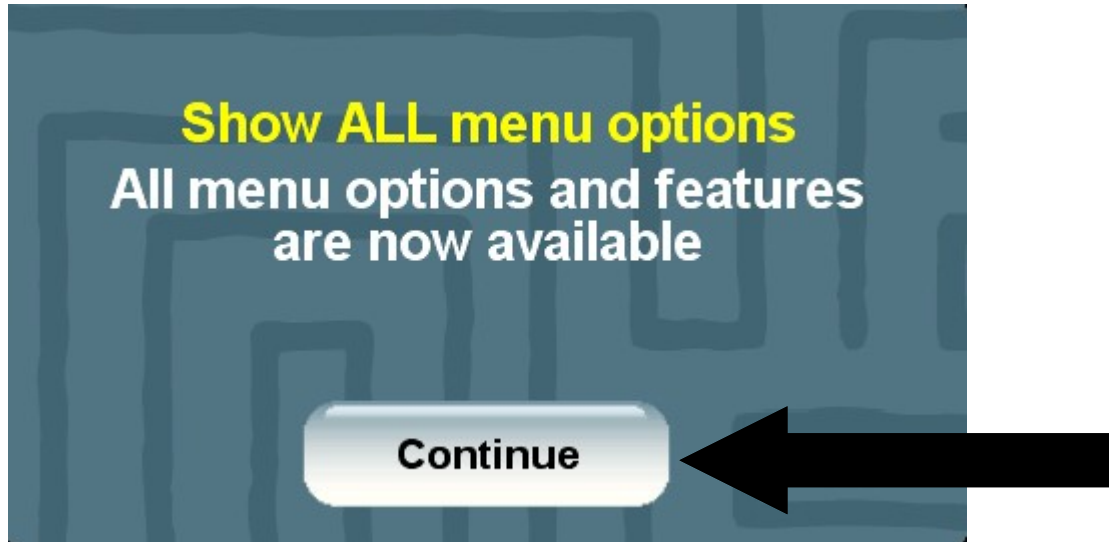

The TomTom will now display many more pages of icons and choices for you to choose.

The Cancel Route icon will now be available on Main Menu 3 or 3 screen.